

|      |                             |      |
|------|-----------------------------|------|
| 8    | LABEL                       | 1    |
| 7    | SCREW M8X25                 | 1    |
| 6    | ROTALOCK 1"-14 UNS          | 1    |
| 5    | BASE SUPPORT Ø90            | 1    |
| 4    | COPPER SLEEVE ODSØ13 (1/2") | 1    |
| 3    | DEEP TUBE ODØ16             | 1    |
| 2    | DEEP HEAD Ø130 TRIMMED      | 1    |
| 1    | DEEP HEAD Ø130 RIMMED       | 1    |
| POS. | DESCRIPTION                 | Q.TY |

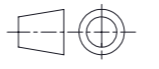

OCS COLD S.R.L.  
Via L.Da Vinci, 8 35020 Brugine (PD) ITALY  
Tel. +39 049 9730184 - Fax +39 049 5806885  
www.ocscold.it - info@ocscold.it

RAL 9005 BLACK POWDER COAT



REFRV1300360C

|                 |        |                                    |          |
|-----------------|--------|------------------------------------|----------|
| VOLUME          | 4L     | CUSTOMER CODE                      | 71000040 |
| DESIGN PRESSURE | 32 BAR | SERIAL                             |          |
| TEST PRESSURE   | 48 BAR | REFRIGERANT                        | HFC, HFO |
| MIN TEMPERATURE | -10°C  | FLUID GROUP(Art.13 Dir.2014/68/UE) | 1        |
| MAX TEMPERATURE | +100°C | PED CATEGORY                       | II       |
| WEIGHT          | 3.44KG | NOTIFIED BODY                      | 0094     |



S.SPINELLO G.BOKARIS  
CHECKED BY DRAFTSMAN

08/10/2024  
DATE

RLV 4L Ø130X360 R1"+ODS1/2" PS32 T-10 GR.1  
DESCRIPTION

GENERAL TOLLERANCE ACCORDING TO EN ISO 13920-C

ALL DIMENSIONS ARE IN mm UNLESS OTHERWISE SPECIFIED